

**HIGHWAYS ACT 1980 AND WILDLIFE AND COUNTRYSIDE ACT 1981
CUMBERLAND COUNCIL**

**CUMBERLAND COUNCIL (PARISH OF MILLOM WITHOUT) PUBLIC PATH CREATION
AND DEFINITIVE MAP AND STATEMENT MODIFICATION ORDER 2024**

This Order is made by Cumberland Council ("the authority") under Section 26 of the Highways Act 1980 ("the 1980 Act") because it appears to the authority that there is a need for the footpath described in the Schedule to this Order and is satisfied that the footpath will add to the convenience and enjoyment of a substantial section of the public and has considered the effect which the creation of the footpath will have on those with an interest in the land.

This Order is also made under section 53A(2) of the Wildlife and Countryside Act 1981 ("the 1981 Act") because it appears to the Authority that the Cumberland Definitive Map and Statement require modification in consequence of the occurrence of an event specified in section 53(3)(a)(i) of the 1981 Act namely the creation (as authorised by this Order) of a highway hitherto shown or required to be shown in the map and statement

BY THIS ORDER:

1. There shall be public footpath over the land situate in the parish of Millom Without described in Part 1 of the Schedule to this Order and shown by black dashed lines on the map contained in this Order on the later of the following events:-
 - (i) The date of first publication of confirmation of this Order;
 - (ii) The date the Highway Authority certifies that all necessary works to bring the footpath described in Part 1 of the Schedule into a fit condition for use have been completedand thereupon the Cumberland Definitive Map shall be modified by adding to it that public right of way.
2. The rights conferred on the public under this Order shall be subject to the limitations and conditions set out in Part 2 of the Schedule to this Order.
3. The Cumberland Definitive Statement shall be modified as described in Part 3 of the Schedule to this Order.
4. The Order shall be referred to as the Cumberland Council (Parish of Millom Without) Public Path Creation and Definitive Map and Statement Modification Order 2024.

Dated the sixteenth day of April 2024

Executed as a Deed by)
Affixing the Common Seal of)
CUMBERLAND COUNCIL)
the presence of :-)

(Kim Smith)



SCHEDULE

PART 1

References on plan.	Description of length of footpath to be created.	Width
Marked with a black dashed line shown A-C-D	A new section of footpath no 416036 at Low Lowscales in the parish of Millom Without from grid reference 315858 481649 northwards for about 36 metres to join FP 416037 at grid reference 315858 481685	2 metres
Marked with a black dashed line shown E-F-B	A new section of footpath no 416036 at Low Lowscales in the parish of Millom Without from the junction with FP 416037 at grid reference 315834 481695 westwards and west-southwestwards for about 69 metres to grid reference 315771 481676	2.5 metres

PART 2

Limitations & Conditions

Grid reference	Limiting item/s or condition/s	Width
315858 481683	Field gate conforming to BS 5709:2018	2.7 metres
315796 481689	Field gate conforming to BS 5709:2018	4.2 metres

PART 3

Addition to Definitive Statement

Path Number	416036	Path type	Footpath
Width	2 metres between GR 315858 481649 & GR 315858 481685 2.5 metres between GR 315834 481695 & GR 315771 481676 at 2024 Creation	Length	1661metres
OS Sheet Number	SD 18 SE	Grid Refs.	316408 481002 to 315281 481764

Description	From road at Beck at junction with FP 415028 (Millom) northwestwards passing along southwest side of Butts Foot Wood to and around Low Lowscales Farm and continuing northwestwards joining FP 416038 from the northeast then continuing westwards
Limitations and Conditions	Field gate conforming to BS 5709:2016 at GR 315858 481683 and 315796 481689
Remarks	Part of path was previously numbered 416036B (100036B) Part Created by Order at Low Lowscales 2024

Path Number	416037	Path type	Footpath
Width	None at 2024 creation	Length	588 metres
OS Sheet Number	SD 18 SE	Grid Refs.	315858 481685 to 316346 481684
Description	From Low Scales east-northeastwards then southeastwards and eastwards to join FP 416035		
Limitations and Conditions	None at 2024 creation		
Remarks	Part of path renumbered 416036 by Creation Order at Low Lowscales 2024		

Confirmed as an unopposed Order this 28 day of May 2024

Executed as a Deed by)

Affixing the Common Seal of)

CUMBERLAND COUNCIL)

the presence of :-)

S.M. Chappell
S.M. Chappell
Solicitor



DATED

2024

**HIGHWAYS ACT 1980 AND WILDLIFE
AND COUNTRYSIDE ACT 1981**

CUMBERLAND COUNCIL

(Parish of Millom Without) Public Path
Creation and Definitive Map and Statement
Modification Order 2024

Chief Legal Officer
Resources
Cumbria House
CARLISLE
CA1 1RZ

Legend

Footpath to be Created - - - - -

Other Rights of Way

Scale 1:750 @ A4

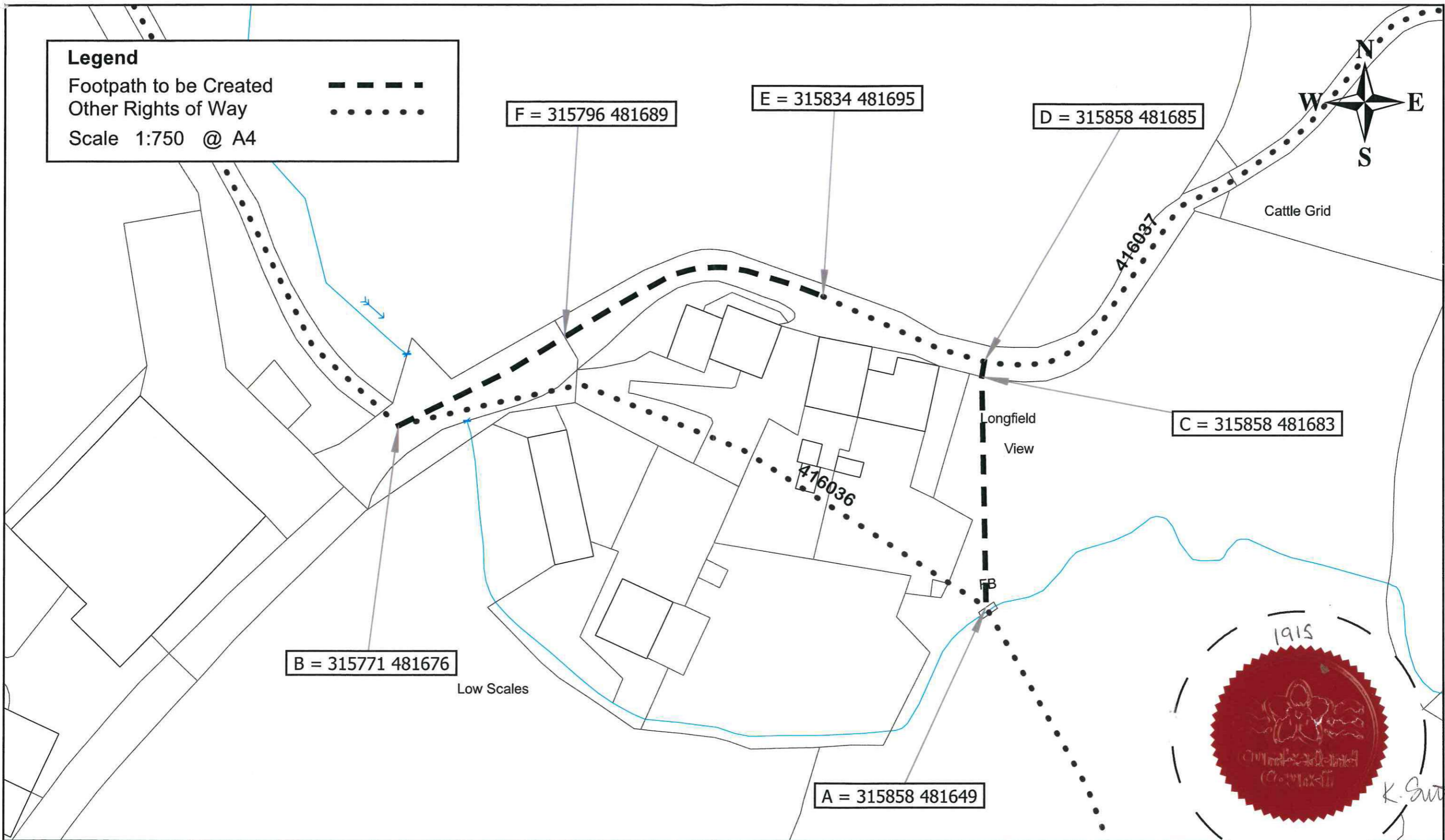

B = 315771 481676

Low Scales

F = 315796 481689

E = 315834 481695

D = 315858 481685

C = 315858 481683

Longfield View

A = 315858 481649



Public Footpath 416036 Creation Order & Public Path Modification Order
Highways Act 1980 Section 26 & Wildlife and Countryside Act Section 53
Low Scales, Millom

