

FORM A



Lake District
National Park

FORM A

APPLICATION FOR A MODIFICATION ORDER

**The Cumbria County Council Definitive Map and/or Statement
within the Lake District National Park - Wildlife and Countryside Act
1981**

To: The Lake District National Park Authority, Murley Moss, Oxenholme Road, Kendal,
Cumbria, LA9 7RL

~~I~~We, PUODON PARISH COUNCIL.....(insert your name)

of BROWFOOT COTTAGE, GRIZE BECK,.....(insert your address)

KIRKBY-IN-FURNESS, CUMBRIA LA17 7XH

hereby apply for an order under section 53(2) of the Wildlife and Countryside Act 1981 modifying the definitive map and/or statement for the area by (choose appropriate section and give grid references if possible):

- (a) ~~Deleting the footpath/bridleway/restricted byway/byway open to all traffic*~~

From:.....

To:.....

- (b) ~~Adding the footpath/bridleway/restricted byway/byway open to all traffic*~~

From: OCCUPATION LANE / STATION ROAD SD2121 8742

To: OCCUPATION LANE / BUSH GREEN SD 2091 8665

- (c) ~~Upgrading/Downgrading the footpath/bridleway/restricted byway/byway open to all traffic*~~

From:.....

To:.....

to a footpath/bridleway/restricted byway/byway open to all traffic *

- (d) ~~Varying/adding to* the particulars relating to the footpath/bridleway/ restricted byway/byway open to all traffic*~~

From:.....

To:.....

By:.....

and shown on the map accompanying this application

I/We **attach copies** of the documentary evidence [including statement of witnesses] in support of this application as listed overleaf

Signed.....[Applicant(s)]

Date 26 July 2021

* Please delete as appropriate

Notes

For historical evidence it is essential to know the date, author, purpose and present whereabouts of the documents listed. Please give as much information as possible.

For statements by witnesses, a form is available from the National Park Authority which suggests the relevant questions to be addressed.

Documentary Evidence in support of application (including witness statements).

- ACT OF PARLIMENT - FURNESS RAILWAYS EXTENSION'S ACT 1846
- ENCLOSURE AWARD BROUGHTON 1828 + MAP
- OCCUPATION LANE - REPORT BY GRANAM GEORGE
- 2 RESIDENT LETTERS
- 5 AFFIDAVITS
- 16 FORM E EVIDENCE STATEMENTS
- 15 MAIL FROM DR DAWSON
-
-
-
-
-
-
-
-
-
-

Other Relevant Information

-
-
-
-
-
-
-
-

I/We enclose with this application:

- ☒ A map clearly showing the route(s) referred to in this application at a good scale
- ☒ Copies of documentary evidence to support this application, as listed above.
- ☒ User evidence (**FORM E**) to support this application – all with a map and signed.
- ☒ A completed form to certify that I/we have served notice on all landowners and occupiers affected by this application (**FORM C**), or a letter explaining why I/we have been unable to ascertain the landowners/occupiers affected by this application and that identifies the steps I/we have taken to find this information (**FORM D**).

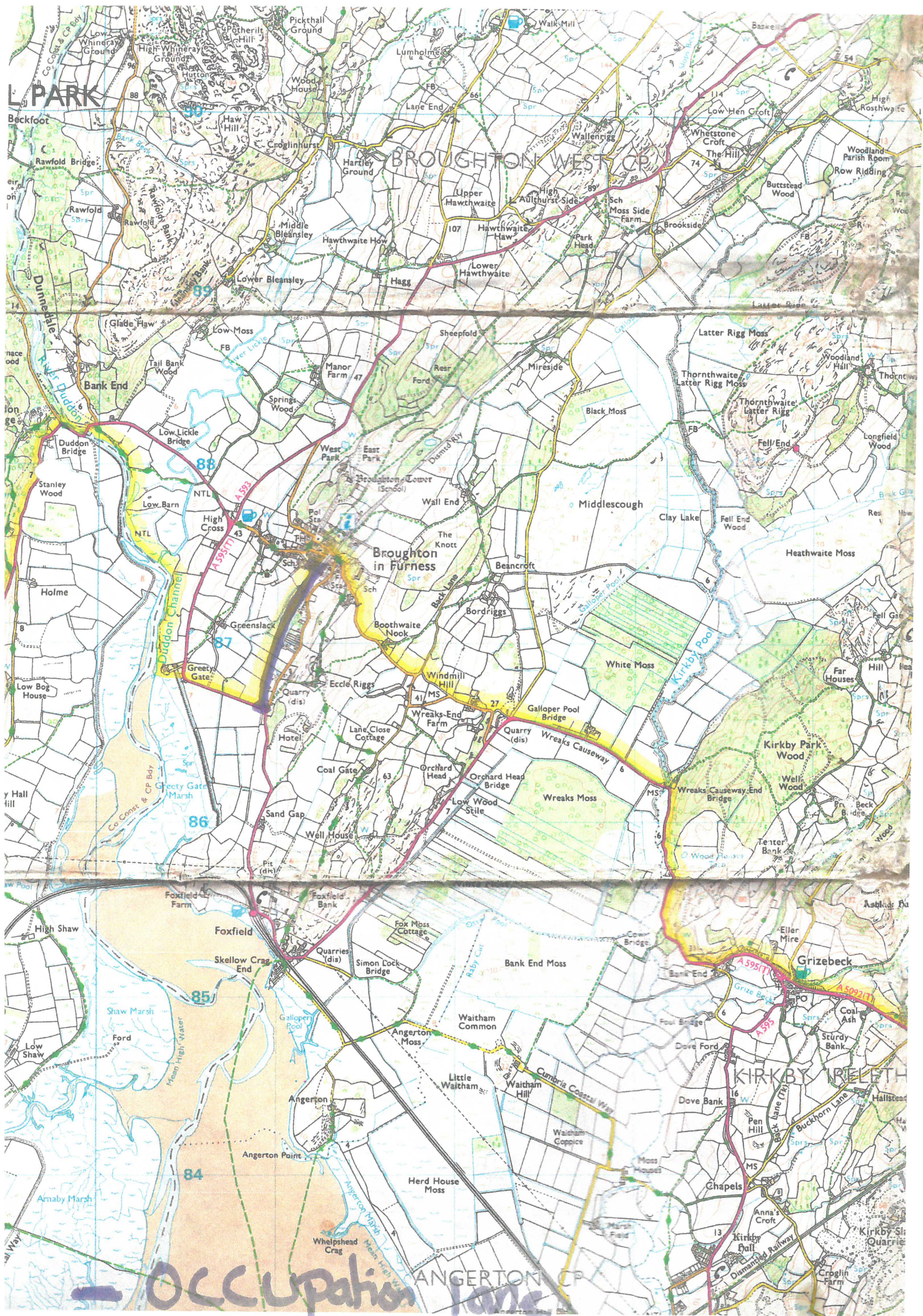

FORM CLake District
National Park**FORM C**

CERTIFICATE OF SERVICE OF NOTICE OF APPLICATION FOR MODIFICATION ORDER

**The Cumbria County Council Definitive Map and/or Statement
within the Lake District National Park - Wildlife and Countryside Act
1981**

To: Lake District National Park Authority
Murley Moss
Oxenholme Road
Kendal
Cumbria
LA9 7RL

I/We, DUODON PARISH COUNCIL.....(insert your name)
Of BROW FOOT COTTAGE, GRIZEBECK.....(insert your address)
KIRKBY-IN-FURNESS, CUMBRIA LA17 7XH.....

hereby certify that the requirements of paragraph 2 of Schedule 14 to the Wildlife & Countryside Act 1981 have been complied with in relation to the attached application.

Signed.....

Date 26 July 2021

NOTES FOR GUIDANCE

This certificate should only be completed when notice of the application has been served on all owners and occupiers affected by the proposal. A list of the names and addresses of all individuals notified should be provided below. Please indicate if you have been unable to identify all owners and occupiers affected by the proposal.

Notice of Application Sent To:

Name	Address
1. <u>Mrs Mrs Swabey</u>	<u>SYLVANA, FOXFIELD ROAD BROUGHTON LA20 6EZ.</u>
2. <u>Mrs Mrs JOHNSON</u>	<u>2 BROUGHTON PARK, BROUGHTON IN FURNESS LA20 6HB</u>
3. <u>Mrs Mrs McGowan</u>	<u>15 BROUGHTON PARK, BROUGHTON IN FURNESS LA20 6HB</u>
4. <u>Mrs Mrs TROSBY</u>	<u>3 BROUGHTON PARK, BROUGHTON IN FURNESS LA20 6HB</u>
5. <u>FURNESS SALLY</u>	<u>FOXFIELD BUSINESS PARK, BROUGHTON LA20 6BX.</u>
6. <u>Mrs Mrs GARNETT</u>	<u>MARJOR FARM, BROUGHTON IN FURNESS LA20 6AB</u>
7. <u>Mrs Mrs WATERSTON</u>	<u>1 BROUGHTON PARK, BROUGHTON IN FURNESS LA20 6HB</u>
8. <u>Dr R R DAWSON</u>	<u>THE GABLES, PARSONS MILL, WOODBRIDGE SUFFOLK IP12 3RB</u>
9. <u>MARY DIXON</u>	<u>FURNESS BUNGALOW, BROUGHTON LA20 6HN</u>
10. <u>Mrs Mrs McGinty</u>	<u>1 TIMMERBROOK HOUSE NETHER WINCHENDEN, HP18 0DZ</u>

Claimed Bridleway - Occupation Lane,
Broughton West Parish

Wildlife & Countryside Act 1981 Section 53A

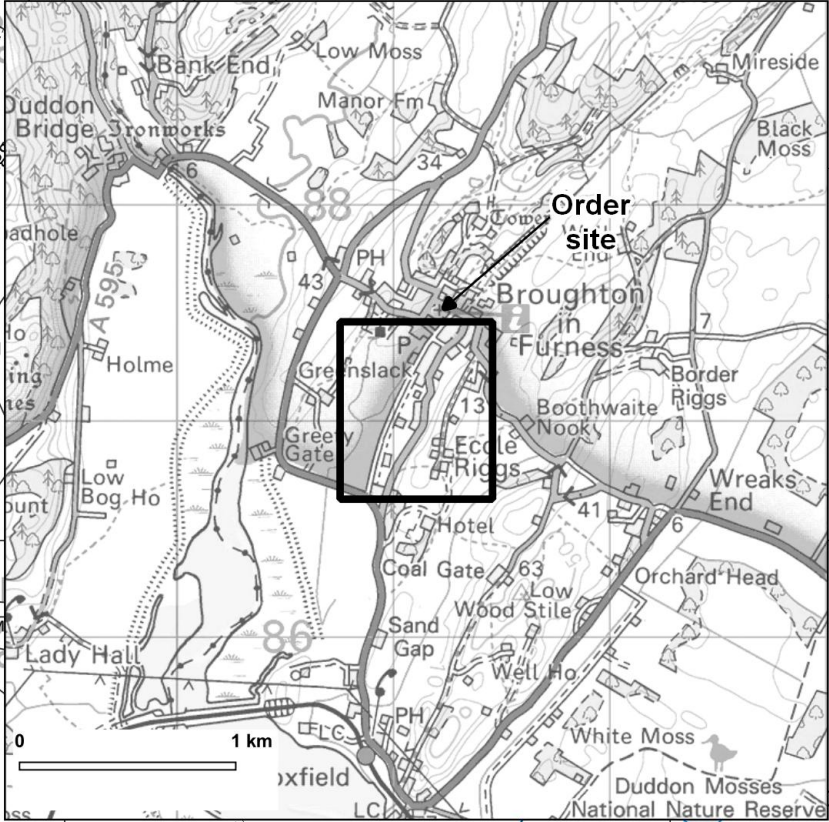
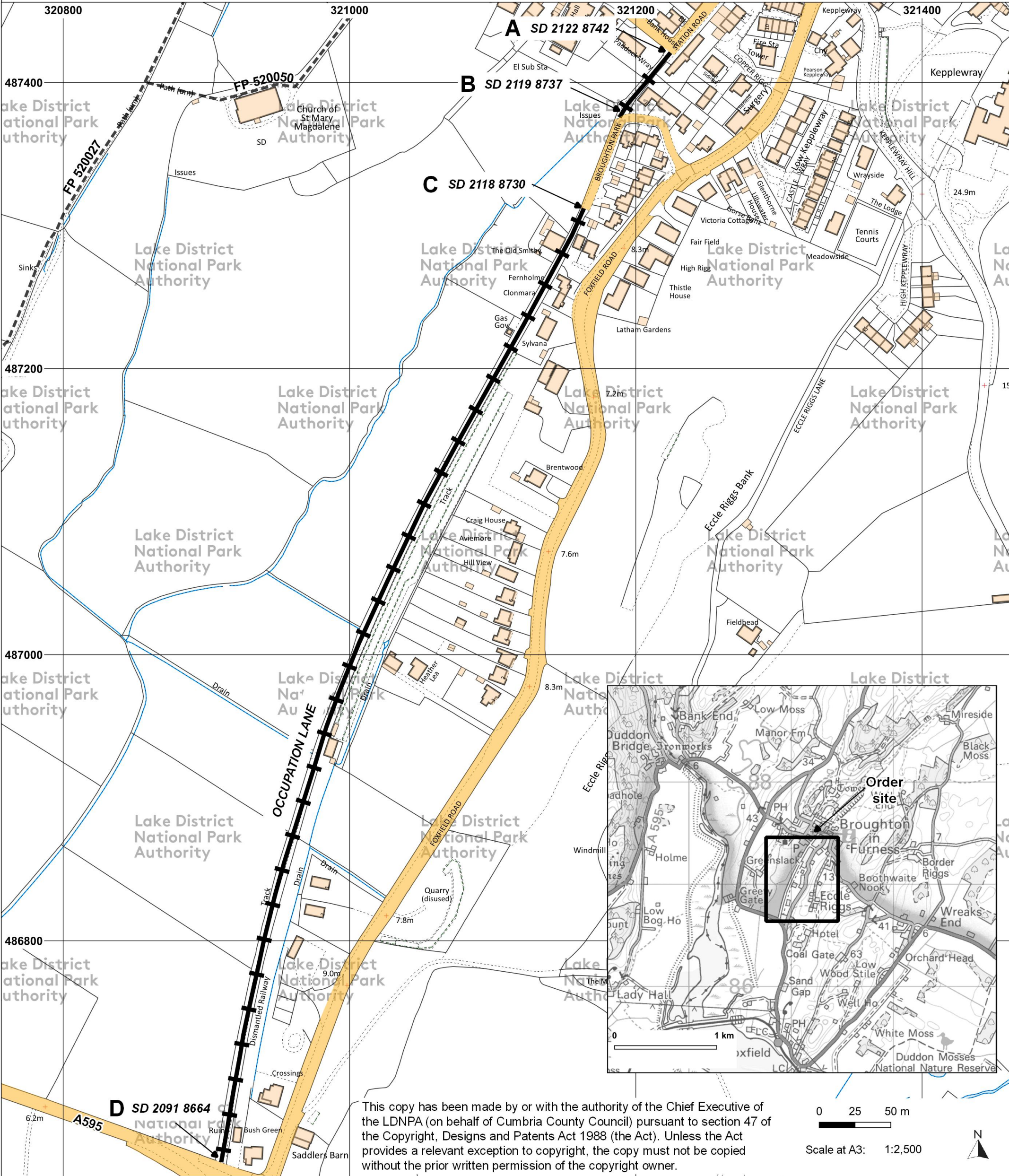

This copy has been made by or with the authority of the Chief Executive of the LDNPA (on behalf of Cumbria County Council) pursuant to section 47 of the Copyright, Designs and Patents Act 1988 (the Act). Unless the Act provides a relevant exception to copyright, the copy must not be copied without the prior written permission of the copyright owner.

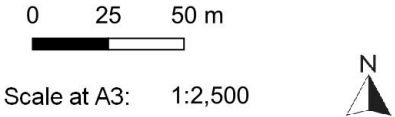

© Crown copyright and database right 2021
Ordnance Survey 100021698

You are not permitted to copy, sub-licence, distribute or sell any of this data to third parties in any form

I:\Corporate Workspaces\Templates\ROW\ModificationsS53\Occupation Lane, Broughton in Furness.qgz

- +— Bridleway to be added
- Unaffected rights of way
- - - Footpath
- Existing public highways (roads)

Centre of map:
SD 2110 8704

Date Authored:
28/07/2021

Authorised signatory:

Date: