

**APPLICATION FOR A MODIFICATION ORDER****WILDLIFE AND COUNTRYSIDE ACT, 1981****The Wildlife and Countryside (Definitive Maps and Statements) Regulations, 1983 (Schedule 7)**DEFINITIVE MAP AND STATEMENT <sup>5</sup> FOR THE PARISH OF BRAMPTON  
and BURTHOLMEDISTRICT OF CARLISLE PUBLIC RIGHT OF WAY NO. 105032

TO: CUMBRIA COUNTY COUNCIL

OF: COUNTRYSIDE ACCESS, THE PARKHOUSE BUILDING, KINGMOOR  
BUSINESS PARK, CARLISLE, CUMBRIA, CA6 4SJI/We (Name of applicant) ANDREW NICHOLSONOf (Address of applicant) % BRAMPTON WALKERS are WELCOME  
3 RIDGEVALE TERRACE  
LANERCOST ROAD  
BRAMPTON, CA8 1EW

hereby apply for an Order under Section 53(2) of the Wildlife and Countryside Act 1981 modifying the Definitive Map and Statements for the area by

- 1
- ~~Deleting the \*(footpath) (bridleway) (restricted byway) (byway open to traffic)~~

~~From:~~~~To:~~

- 2
- ~~Adding the \*(footpath) (bridleway) (restricted byway) (byway open to traffic)~~

From: Easby Lane End near BramptonTo: Lanercost

- 3
- ~~\*(Upgrading) (downgrading) to a \*(footpath) (bridleway) (restricted byway) (byway open to all traffic) the \*(footpath) (bridleway) (restricted byway) (byway open to all traffic)~~

~~From:~~~~To:~~

- 4 ~~\*(Varying) (adding to) the particulars relating to the \*(footpath) (bridleway) (restricted byway) (byway open to all traffic)~~

~~From:~~

~~To:~~

and shown on the map attached. ✓

- \* Please delete as appropriate

I/We attach copies of the following documentary evidence (including statements of witnesses) in support of this application:

List of Documents provided

- (hard copies)
1. Misc. documents, as listed ~~—~~ digitally on Excel spreadsheet.
  2. Witness forms and maps (hard copies) as listed above.
  3. Misc. leaflets, brochures and guides (hard copies) publicising Quarrybeck footpath, as listed above.

Dated 24<sup>th</sup> July 20

Signed .

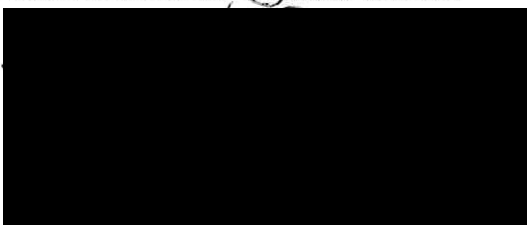

# QUARRYBECK FOOTPATH

Ownership details.  
Current alignment.

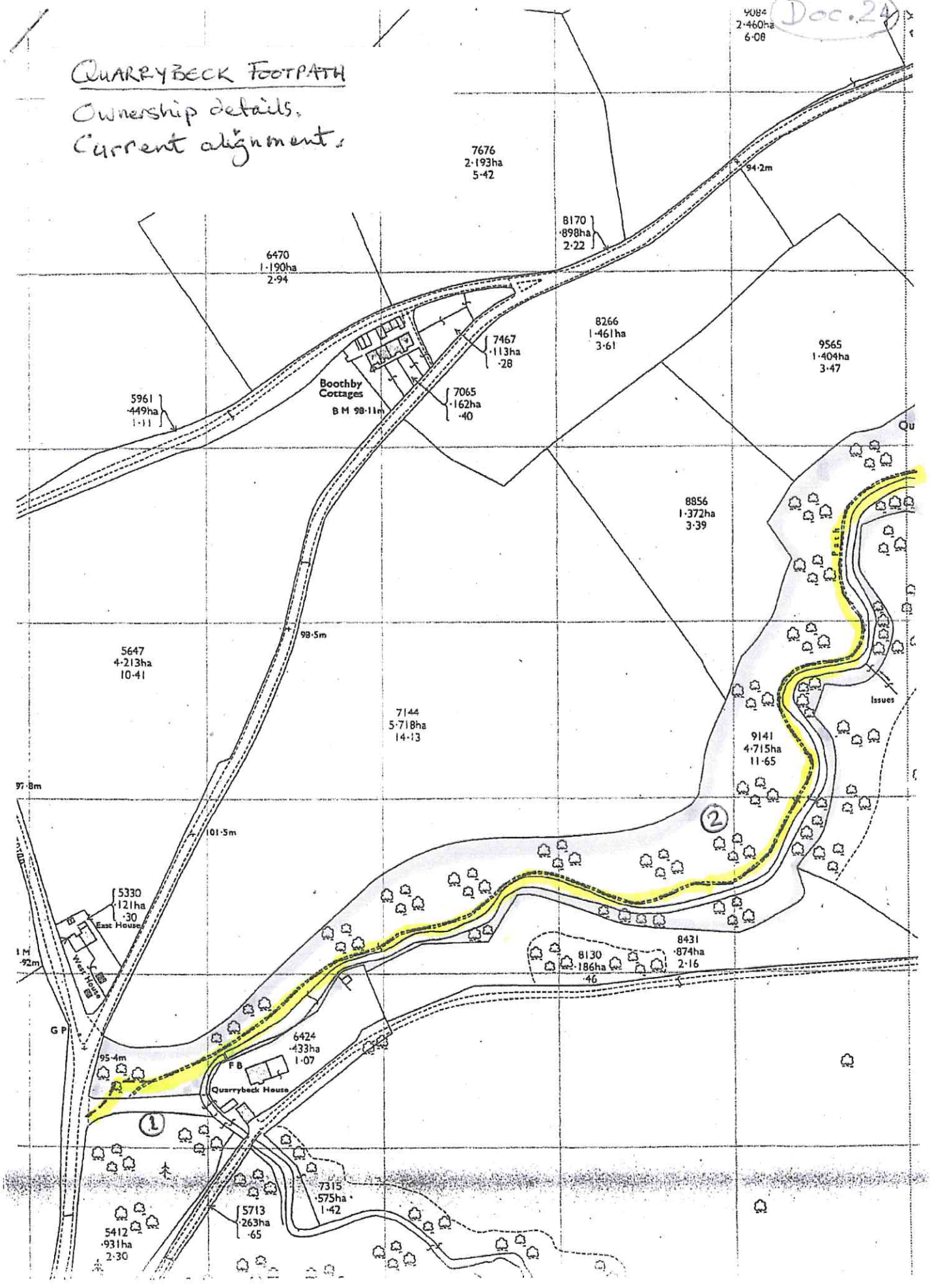



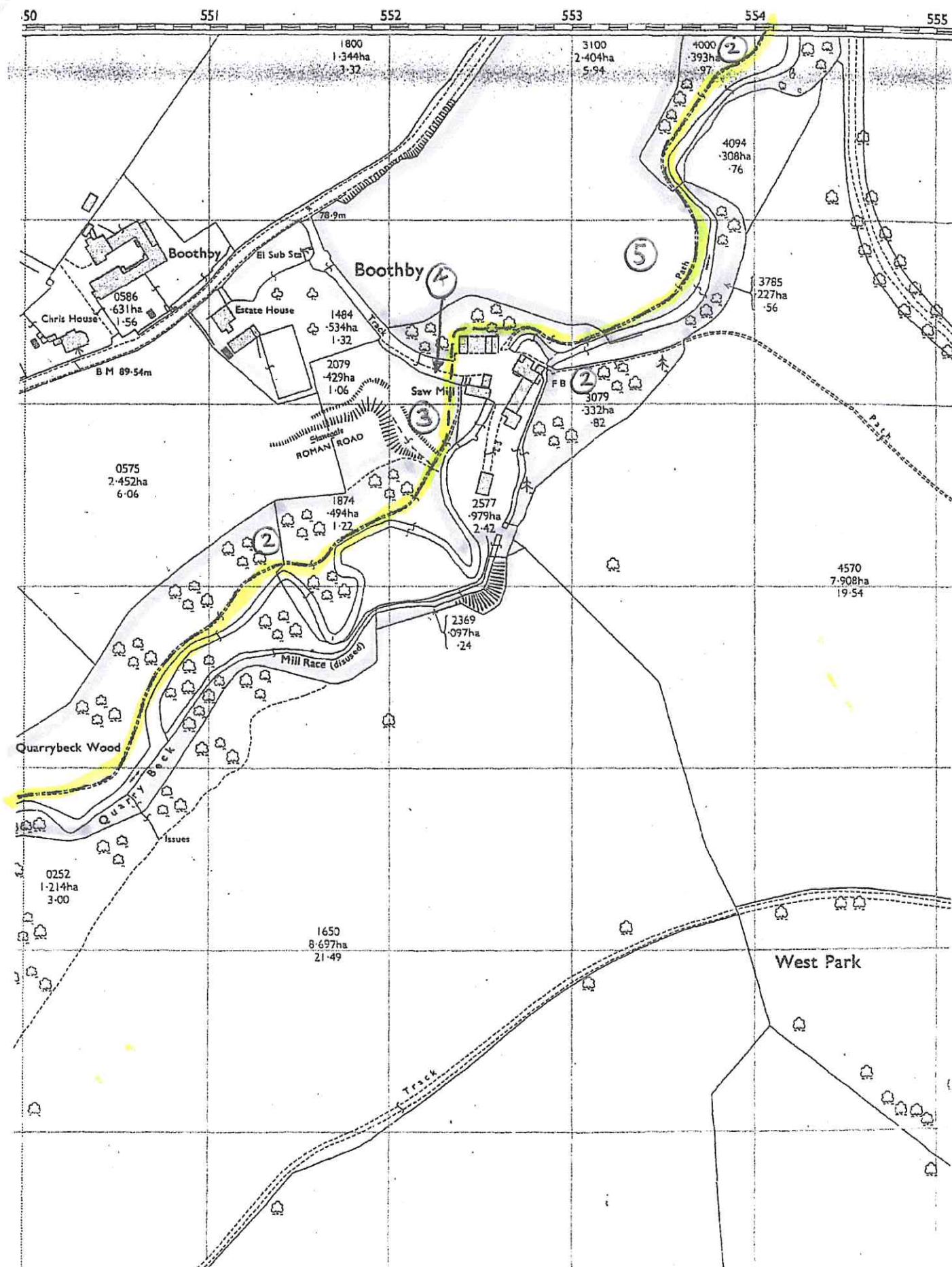

Doc. 24

