

**APPLICATION FOR A MODIFICATION ORDER****WILDLIFE AND COUNTRYSIDE ACT, 1981****The Wildlife and Countryside (Definitive Maps and Statements)  
Regulations, 1983 (Schedule 7)**DEFINITIVE MAP AND STATEMENT FOR THE PARISH OF LOWER ALLTHWAITEDISTRICT OF CARTMEL PUBLIC RIGHT OF WAY NO. ....

TO: THE HEAD OF LEGAL SERVICES, CUMBRIA COUNTY COUNCIL

OF: THE COURTS, CARLISLE, CUMBRIA, CA3 8LZ

I/We (Name of applicant) DAVID UNSWORTH ? SUSAN GILLOf (Address of applicant) 2 THE FLAGS CORNBROOK URM AND  
CARTMEL CHASSER BECK  
L11 6PN CARTMEL L11 6PNhereby apply for an Order under Section 53(2) of the Wildlife and Countryside Act 1981  
modifying the Definitive Map and Statements for the area by

- 1 ~~Deleting the \*(footpath) (bridleway) (restricted byway) (byway open to traffic)~~

From:

To:

- 2 ~~Adding the \*(footpath) (bridleway) (restricted byway) (byway open to traffic)~~

From: FORD ROAD CARTMELTo: PENNY BRIDGE CARTMEL

- 3 \*(Upgrading) (downgrading) to a \*(footpath) (bridleway) (restricted byway) (byway open to all traffic) the \*(footpath) (bridleway) (restricted byway) (byway open to all traffic)

From:

To:

- 4 \*(Varying) (adding to) the particulars relating to the \*(footpath) (bridleway) (restricted byway) (byway open to all traffic)

From:

To:

By providing that

and shown on the map annexed hereto.

\* Please delete as appropriate

I/We attach copies of the following documentary evidence (including statements of witnesses) in support of this application:

List of Documents provided

16 - WCA 8 FORMS.

PHOTO SHOWING FOOTPATH on 12/5/2000.

PHOTO SHOWING FOOTPATH on 18/11/2007 showing  
gate blocking entry - path overgrown.

Date 18/11/07

Signed



# Land Registry Current title plan

Title number CU192428  
Ordnance Survey map reference SD3778NE  
Scale 1:1250  
Administrative area CUMBRIA: SOUTH  
LAKELAND

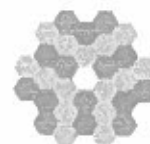

© Crown Copyright. Produced by Land Registry. Reproduction in whole or in part is prohibited without the prior written permission of Ordnance Survey. Licence Number 100026316.

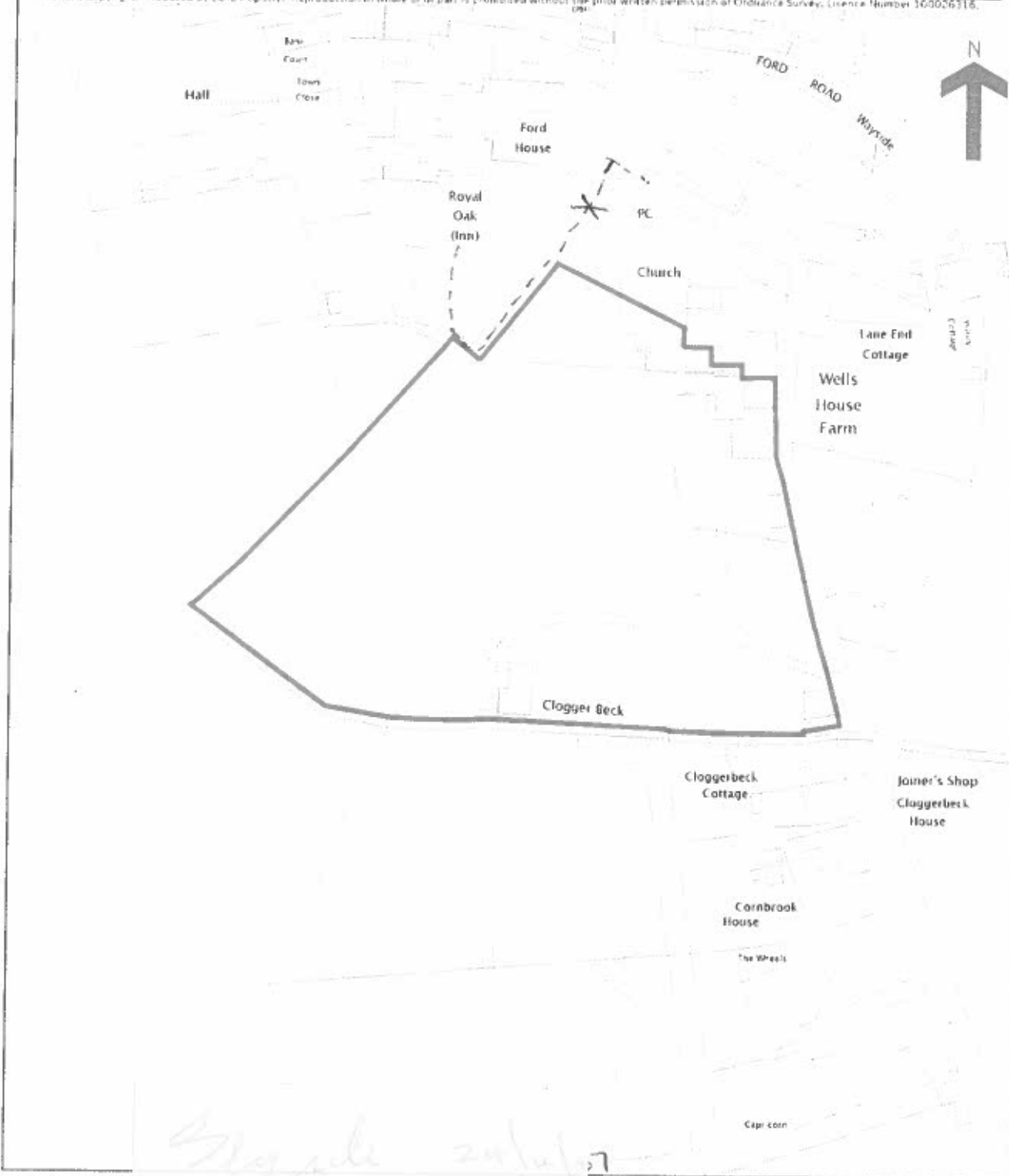

*Stagade 24/1/07*  
*South Lakeland*  
*IV.07*

This is a copy of  
it still pending in  
This copy is not a  
extent as the origi  
If you want to obt  
The Land Registr  
depend on your p  
boundaries. It m  
points on the gro

This title is dealt with by Land Registry, Durham (Durham) Office.

it take account of any application made after that time even

plan is admissible in evidence in a court to the same  
he suffers loss by reason of a mistake in an official copy.  
to do this.

the plan images. The quality and accuracy of any print will  
ws the general position, not the exact line, of the  
in this plan may not match measurements between the same

